

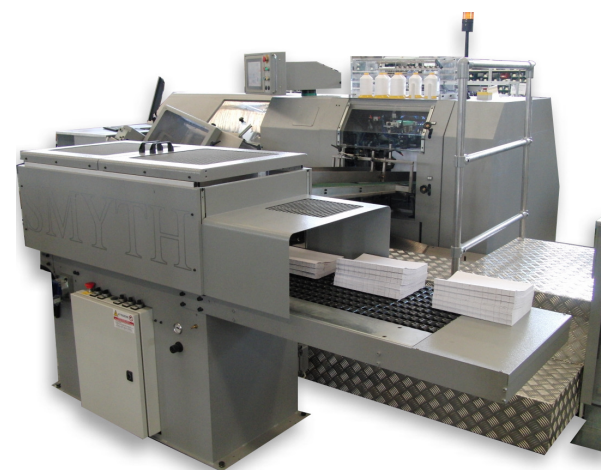

New camera control of the correct gathering sequence in the hopper (option)



Freccia Smyth mod. **HELPER** is the stacker that makes piles of sewn books coming from the sewing machine in order to facilitate the operator in the discharge operations. The separation of books is made by a "comb" system for normal thickness books and a suckers system for thin books. The books pile is programmable up to 150 mm height. (option)



BOOK SEWER F180 4D

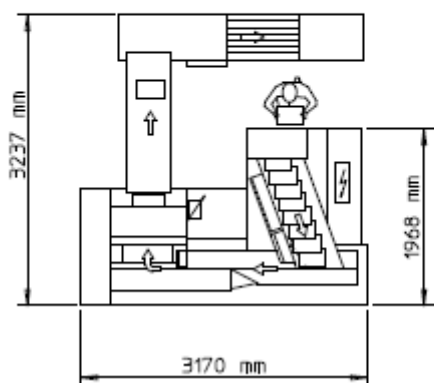
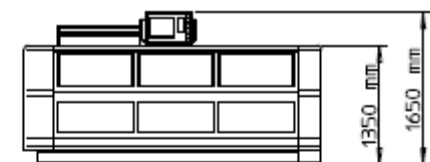

TECHNICAL FEATURES

Signature Size max.	320 X 420 mm.
min.	80 x 150 mm.
Mechanical speed max.	180 cycles/min.
Air Consumption (external supplied). To optimize the functioning the air must to be drier	
	300 NI/min. 6 bar
Openings	4 above , 4 below
Stitches number	nine
Stitch lenght	24 mm.
Electrical	7 Kw
Total weight	3500 kg
Dimension	3,17 x 1,96 x h 1,65mt.

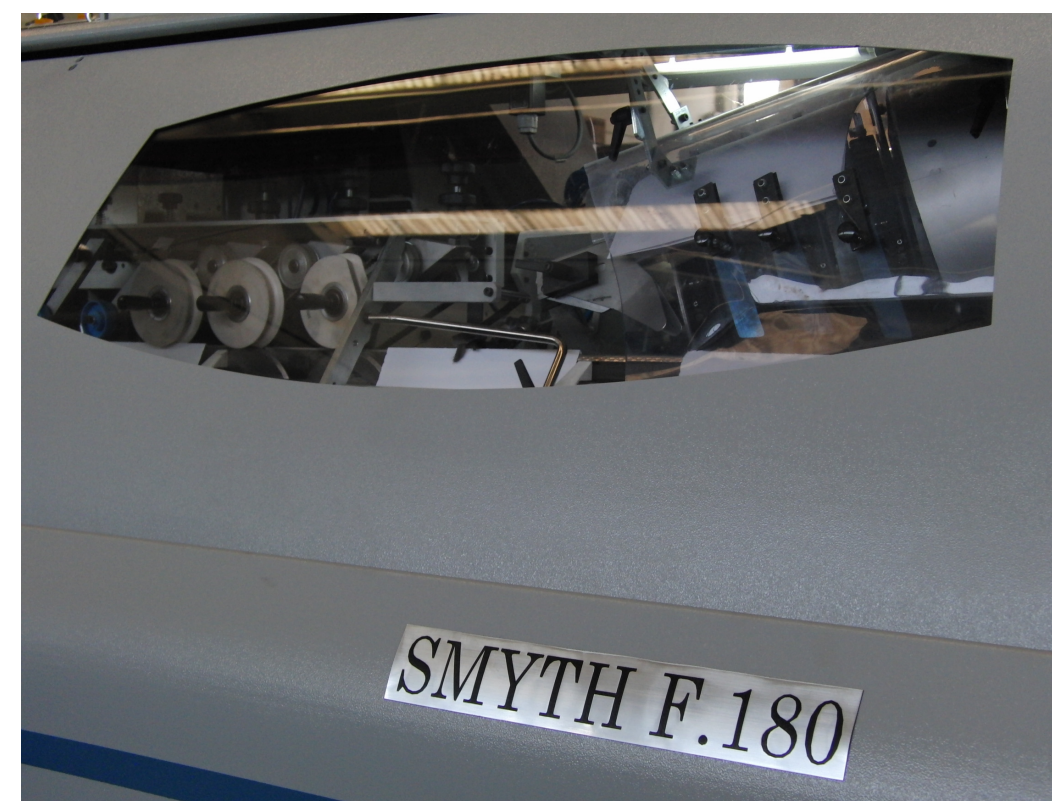

Automatic Book Sewing Machine

SMYTH F180 4D

Smyth s.r.l. Regione Formica 10 S.S.31 Casale-Torino, 15030 Coniolo (AL) Italy

tel.: 0142-56.33.66 fax: 0142-56.22.77 e-mail: freccia@smyth.it sito web: www.smyth.it



BOOK SEWING MACHINE F180 4D

Sturdiness and quality are the pillars on which the engineering philosophy of the Smyth F180 is founded. Innovation offering bookbinders the most advanced solutions is a Freccia Smyth tradition. Reliability, as the trust of bookbinders in the equipment, grows and together with the experience gained with the long life of a company affords that the performance of the F180sewer satisfies all production range of sewn books



PROGRAMMING

The computer handles via servo motors the main size adjustments entered by the operator. New touch screen monitor is placed on a pivoting console for easy accessibility from either side of the machine.

The following functions can be programmed:

- Programming of 4 upper and 4 lower openings
- Programming of LAP opening device
- Programming of speed variation of the main motor and infeed wheel
- Programming of the signature gluing device (optional)
- Programming of control of the gathering sequence (optional)
- Management of the automatic lubrication system
- Management of the electric motor control
- Diagnostic of the electro-mechanical functions
- Possibility of the diagnostic service via modem connection.

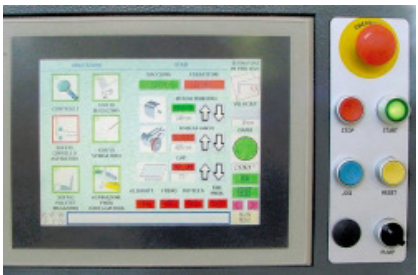

LOADING, FEEDING AND OPENING

Signatures to be sewn are loaded in the hopper. A photocell gathering control (optional) monitors the correct sequence of gathered signatures and stops the machine in case of mistake. The signatures are transported through the opening section in a shingled stream by means of geared belts. This unique system reduces by 50% the travelling speed of the signature, compared to a conventional transport of a signature at a time. Contact time with the vacuum openers is longer and the special movement of the suckers-radial rotation- ensures a gentle and precise opening of the signature even in presence of porous paper, heavy perforation and static electricity. The LAP opening device - standard in the F180 - is ready to work when programmed and does not require any installation. On request, a second LAP opener can be installed which will make it possible to have two additional vacuum-openings after the LAP. For porous paper, Ventura-type openings are available.

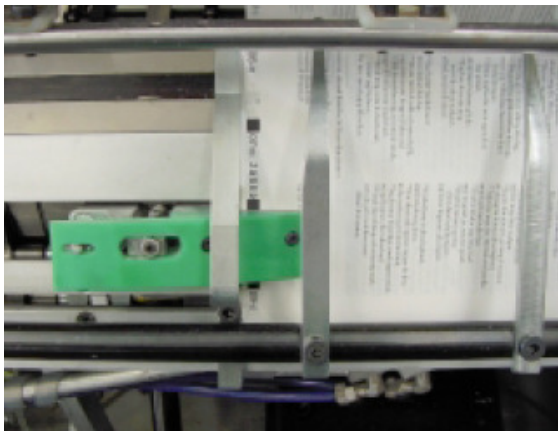
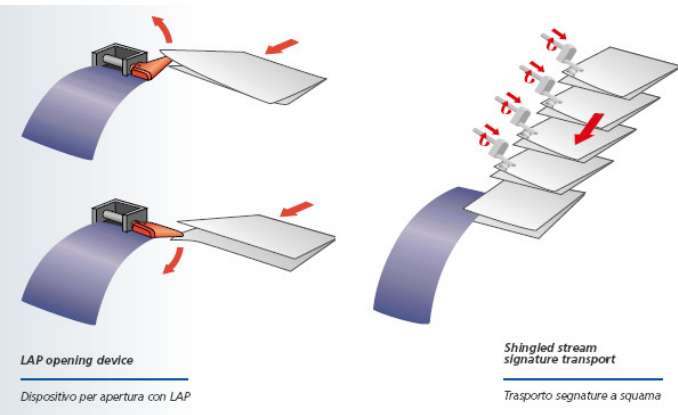

VACUUM HEADING UP SYSTEM

A mixed Vacuum and Pressure system to make easy pulled against register header inserted signature. In presence of signature not inserted the vacuum system is switch off allowing the heading up system to work only with the pressure.

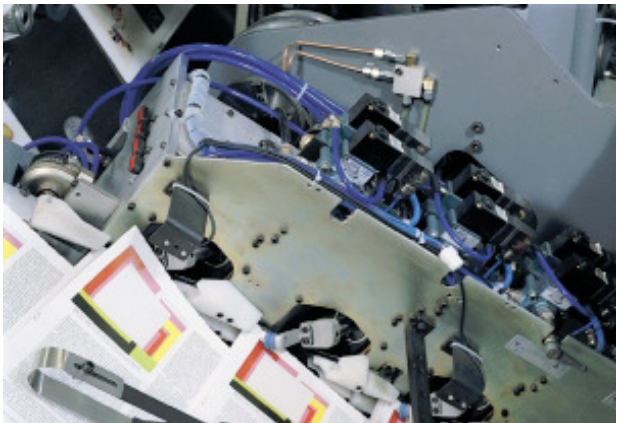

ROTATING TRASLATING SUCKERS CARRIAGE

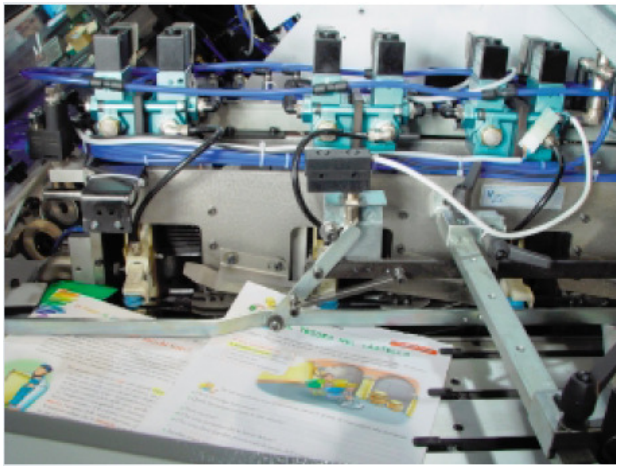

TRANSLATING MOTION SUCKERS CARRIAGE



TOP SADDLE CONTROL

A precise signatures locking system, on the top of the saddle, assure the perfect centering of the stitches on the signature back.